



M Series 1.5-compact 4.0t Internal Combustion Forklift



M Series Forklift Truck



Hyster-Yale Maximal Forklift (Zhejiang) Co., Ltd

Address No.1, jinxin Road, Lushan Industrial area, Fuyang, Zhejiang China

Tel 0086-571-28001566
0086-571-28935028
0086-571-28979902

Fax 0086-571-28001569

Email

For sales

info@maxforklift.com

For spare parts

parts@maxforklift.com

All rights reserved.

If any doubt, please contact us.



MAXIMAL FAMILY



We work for maximal



Maximal Company Introduction



Established in Feb. 2006, Hyster-Yale Maximal Forklift (zhejiang) Co., Ltd, is located in Lushan Industry Area with convenient transportation. Maximal specializes in material handling equipment designing and manufacturing.

Maximal Company total floor area is 133,334 m², investment RMB420 million, factory designed production capacity is 30000 units per year.

Currently Maximal employs 500 staffs, with more than 230 professional and technical personnel, more than 70 Technical R&D personnel. Maximal gained 7 national invention patents, more than 70 utility model and appearance patents.

Maximal owns advanced parts processing center, robot welding equipments, parts automatic hoist conveyor lines, coating lines, assembly lines, forklifts performance test lines, parts test-bed and ERP information management system.

Maximal current product range covers 4 series, including 1.5-compact12T industrial forklift, 1.8-5.0T rough terrain forklift, 13.5-32.0T heavy duty forklift & Port machinery and warehouse equipment.

Maximal forklifts received strong public recognition for their modern and striking appearance, high production quality, safety standard and low cost of operation.

At present, Maximal products sales have covered all provinces in domestic market, exported to over 100 countries and areas. Maximal takes "technology innovation, promoting products structure, improving product quality and service" as the belief, takes internationalization, professionalization and green environmental protection as mission, to build Maximal into the most respectable forklift brand.

Current products consist of:

M series:

- 1.5-32T/3000-64,000LB capacity diesel forklifts.
- 1.5-7T/3000-14,000LB capacity gasoline/LPG forklifts.
- 4-5T/8000-10,000LB capacity 4-wheel electric forklifts.
- 1.6-2T/3200-4000LB capacity 3-wheel electric forklifts.
- 0.7-1.5T/1400-3000LB capacity VNA truck.
- 1.6T/3200LB capacity Rear drive 3-wheel electric forklifts.
- 2.5T/4000-5000LB capacity dual-drive 4-wheel electric forklifts.
- 2.5T/4000-5000LB capacity cushion tyre forklifts.
- 1.3-3T/2600-6000LB capacity Omni-Directional electric forklifts.

A series:

- 2.5-3.5T/4000-7000LB capacity diesel and gasoline/LPG forklifts.

- 1.5-3.5T/3000-7000LB capacity 4-wheel electric forklifts.
- 1.6-2.5T/3200-5000LB capacity electric reach truck.

Rough Terrain:

- 1.8-3.5T/3600-7000LB capacity compact 4WD rough terrain forklifts.
- 2.5-3.5T/5000-7000LB capacity 4WD rough terrain forklifts.
- 1.8-5.0T/3600-10,000LB capacity 2WD rough terrain forklifts.

Port Machinery:

- 9T/18,000LB capacity empty container handler.
- 45T/90,000LB capacity reach stacker.

Side Loader Forklift:

- 3.5T-4.5T/7000-9900LB capacity side loader forklifts.

M series introduction

The M series is the first generation forklifts, designed by the MAXIMAL engineering team. A world class design is featured as advanced technologies and superior componentry produced by competitive vendors over the world. The finished appearance with safety color design has attracted an audience in local and the world markets.

Classification of After-sales Service

Classification of After-sales Service classifies customer claims into 3 classes, Warranty 1(W1), Warranty 2(W2), Warranty 3(W3). Different claim class has different after-sales procedures which aims to increase service quality.



Classification of After-sales Service



24-hour fast reply on trucks and parts claims



Ergonomic design



High quality components



Safety operation





M SERIES 1.5-1.8t Diesel forklift

| General | 1 | Model | | FD15T-M2 WC3 | FD18T-M2 WC3 | |
|--------------------------|---|---------------------------------------|-------------------------------------|---------------------------------------|--------------|------|
| | | 2 | Optional type | | G(6)3 | |
| | 3 | Rated capacity | kg | 1500 | 1800 | |
| | 4 | Load centre | mm | 500 | | |
| Characteristic&Dimension | 5 | Lift height | mm | 3000 | | |
| | 6 | Free lift height | mm | 135 | | |
| | 7 | Fork size | L×W×T | 920×100×35 | 920×100×35 | |
| | 8 | Fork regulating range | Min./Max. | 200/890 | | |
| | 9 | Mast tilt angle | F/R | 6°/12° | | |
| | 10 | Front overhang | mm | 400 | | |
| | 11 | Rear overhang | mm | 465 | 510 | |
| | 12 | Min. ground clearance(Bottom of mast) | mm | 130 | | |
| | Overall dimensions | 13 | | Length to face of fork (without fork) | 2255 | 2300 |
| | | 14 | | Overall width | 1070 | |
| | | 15 | | Mast lowered height | 2015 | |
| | | 16 | | Mast extended height(with backrest) | 3984 | |
| | | 17 | | Overhead guard height | 2110 | |
| | 18 | Turning radius(outside) | mm | 2040 | 2075 | |
| 19 | Min. right angle stacking aisle width (add load length and clearance) | mm | 1825 | 1857 | | |
| Performance | 20 | Speed | Travel(Unladen) | 14.5 | | |
| | 21 | | Lifting(Laden) | 550(WC3) | | |
| | 22 | | Lowering(Laden) | 450 | | |
| | 23 | Max. Drawbar pull(Laden/unladen) | KN | 18/16 | | |
| 24 | Max. Gradeability(Laden) | % | 20 | | | |
| Tyre | 25 | Tyre | Front | 6.50-10-10PR | | |
| | 26 | | Rear | 5.00-8-8 PR | | |
| | 27 | Tread | Front | 890 | | |
| | 28 | | Rear | 920 | | |
| | 29 | | Wheelbase | 1400 | | |
| Weight | 30 | Self weight | kg | 2590 | 2800 | |
| | Weight Distribution | Laden | Front Axle | 3520 | 3950 | |
| | | | Rear Axle | 570 | 650 | |
| | | Unladen | Front Axle | 1160 | 1260 | |
| Rear Axle | | | 1430 | 1540 | | |
| Power&Transmission | 35 | Battery | Voltage/Capacity | 12/90 | | |
| | 36 | | Fuel tank capacity | L 50 | | |
| | 37 | | Manufacture | China | | |
| | 38 | Transmission | Type | Powershift | | |
| | | | Stage | F/R 1/1 | | |
| | 39 | | Operating pressure(For attachments) | MPa | 14.5 | |

M SERIES 1.5-1.8t Gasoline&LPG forklift

| General | 1 | Model | | FGL15T-M2 WB3 | FGL18T-M2 WB3 | |
|--------------------------|---|---------------------------------------|-------------------------------------|---------------------------------------|---------------|------|
| | | 2 | Rated capacity | kg | 1500 | 1800 |
| | 3 | Load centre | mm | 500 | | |
| Characteristic&Dimension | 4 | Lift height | mm | 3000 | | |
| | 5 | Free lift height | mm | 135 | | |
| | 6 | Fork size | L×W×T | 920×100×35 | | |
| | 7 | Fork regulating range | Min./Max. | 200/890 | | |
| | 8 | Mast tilt angle | F/R | 6°/12° | | |
| | 9 | Front overhang | mm | 400 | | |
| | 10 | Rear overhang | mm | 465 | 510 | |
| | 11 | Min. ground clearance(Bottom of mast) | mm | 130 | | |
| | Overall dimensions | 12 | | Length to face of fork (without fork) | 2255 | 2300 |
| | | 13 | | Overall width | 1070 | |
| | | 14 | | Mast lowered height | 2015 | |
| | | 15 | | Mast extended height(with backrest) | 3984 | |
| | | 16 | | Overhead guard height | 2110 | |
| | 17 | Turning radius(outside) | mm | 2040 | 2075 | |
| 18 | Min. right angle stacking aisle width (add load length and clearance) | mm | 1825 | 1857 | | |
| Performance | 19 | Speed | Travel(Unladen) | 14.5 | | |
| | 20 | | Lifting(Laden) | 380 | | |
| | 21 | | Lowering(Laden) | 450 | | |
| | 22 | Max. Drawbar pull(Laden/unladen) | KN | 17/15 | | |
| 23 | Max. Gradeability(Laden) | % | 20 | | | |
| Tyre | 24 | Tyre | Front | 6.50-10-10PR | | |
| | 25 | | Rear | 5.00-8-8 PR | | |
| | 26 | Tread | Front | 890 | | |
| | 27 | | Rear | 920 | | |
| | 28 | | Wheelbase | 1400 | | |
| Weight | 29 | Self weight | kg | 2590 | 2800 | |
| | Weight Distribution | Laden | Front Axle | 3520 | 3950 | |
| | | | Rear Axle | 570 | 650 | |
| | | Unladen | Front Axle | 1160 | 1260 | |
| Rear Axle | | | 1430 | 1540 | | |
| Power&Transmission | 34 | Battery | Voltage/Capacity | 12/60 | | |
| | 35 | | Fuel tank capacity | L 50 | | |
| | 36 | | Manufacture | China | | |
| | 37 | Transmission | Type | Powershift | | |
| | | | Stage | F/R 1/1 | | |
| | 38 | | Operating pressure(For attachments) | MPa | 14.5 | |



YANMAR

Type: WC3
 Model: 4TNE92 (Eu IIIA)
 Rated output: 33kw/2450 rpm
 Rated torque: 150 N · m /1600 rpm
 No. of cylinder:4
 Bore × Stroke: 91 × 110 mm
 Displacement: 2.659 L



XINCHAI

Type: G(6)3
 Model: 4N23G31-007
 Rated output: 30kw/2600rpm
 Rated torque: 131N.M (1700-1900) rpm
 No. of cylinder:4
 Bore × Stroke: 85 × 100mm
 Displacement: 2.27L



GCT

Type: WB3
 Model: K21
 Rated output: 31.2kw/2250rpm
 Rated torque: 143.7N · m/1800rpm
 No. of cylinder:4
 Bore × Stroke:89 × 83mm
 Displacement:2.065L

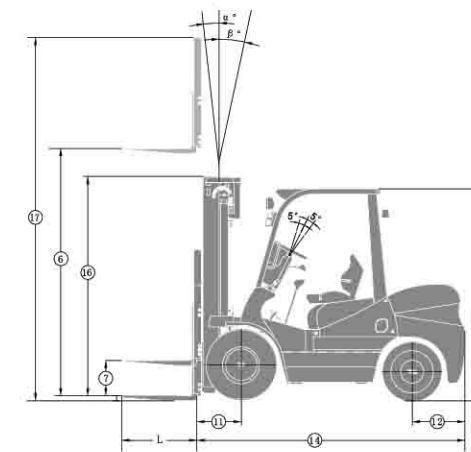
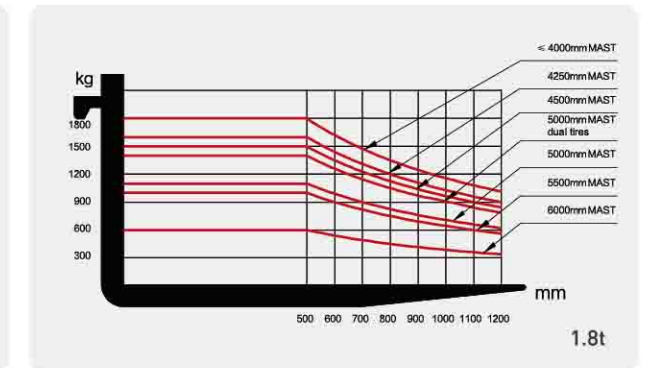
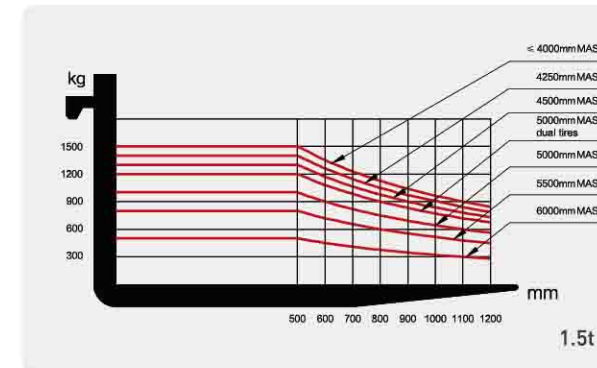

a=200 mm safety clearance
 $AST=a+\textcircled{1}+\textcircled{9}+\sqrt{W^2+(B/2)^2}$

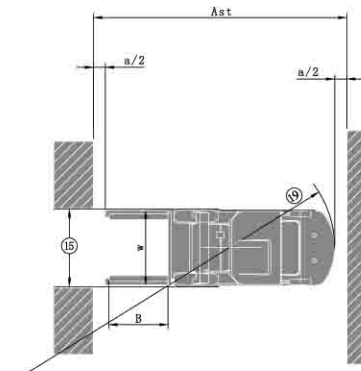

M SERIES 1.5-1.8t mast:

| Type | Model | Max. fork height | Overall height | | | | | | Free lift | | Front Overhang | | Tilt range | | Capacity load capacity at 500mm | | | |
|------------------------|--------|------------------|----------------|------|----------|------|------------------|---------------|-----------|------|----------------|-----|-------------|------|---------------------------------|------|------|------|
| | | | Lowered | | Extended | | Without backrest | with backrest | 1.5t | 1.8t | FWD | BWD | Single tyre | | Double tyre | | | |
| | | | 1.5t | 1.8t | 1.5t | 1.8t | | | | | | | 1.5t | 1.8t | 1.5t | 1.8t | | |
| 2-stage mast | M330 | 3300 | 2165 | 2165 | 3813 | 3813 | 4284 | 4284 | 135 | 135 | 400 | 400 | 6 | 12 | 1500 | 1800 | — | — |
| | M350 | 3500 | 2265 | 2265 | 4013 | 4013 | 4484 | 4484 | 135 | 135 | 400 | 400 | 6 | 12 | 1500 | 1800 | — | — |
| | M370 | 3700 | 2365 | 2365 | 4213 | 4213 | 4684 | 4684 | 135 | 135 | 400 | 400 | 6 | 6 | 1500 | 1800 | — | — |
| | M400 | 4000 | 2565 | 2565 | 4513 | 4513 | 4984 | 4984 | 135 | 135 | 400 | 400 | 6 | 6 | 1400 | 1600 | — | — |
| | M450 | 4500 | 2815 | 2815 | 5013 | 5013 | 5484 | 5484 | 135 | 135 | 400 | 400 | 6 | 6 | 1300 | 1500 | — | — |
| | M500 | 5000 | 3065 | 3065 | 5513 | 5513 | 5984 | 5984 | 135 | 135 | 400 | 400 | 6 | 6 | 800 | 1000 | 1000 | 1200 |
| | M550 | 5500 | 3365 | 3365 | 6013 | 6013 | 6484 | 6484 | 135 | 135 | 400 | 400 | 3 | 6 | 500 | 600 | 800 | 1000 |
| Full free 2-stage mast | M600 | 6000 | 3615 | 3615 | 6513 | 6513 | 7013 | 7013 | 1165 | 780 | 400 | 400 | 6 | 12 | 1500 | 1800 | — | — |
| | FM300 | 3000 | 2015 | 2015 | 3513 | 3513 | 3984 | 3984 | 1415 | 1030 | 400 | 400 | 6 | 12 | 1500 | 1800 | — | — |
| | FM330 | 3300 | 2165 | 2165 | 3813 | 3813 | 4284 | 4284 | 1765 | 1380 | 400 | 400 | 6 | 6 | 1500 | 1800 | — | — |
| Full free 3-stage mast | FM350 | 3500 | 2565 | 2565 | 4513 | 4513 | 4984 | 4984 | 1965 | 1580 | 400 | 400 | 6 | 6 | 1500 | 1800 | — | — |
| | TFM435 | 4350 | 2015 | 2015 | 4863 | 4863 | 5334 | 5334 | 1420 | 1030 | 400 | 400 | 6 | 6 | 1250 | 1500 | — | — |
| | TFM450 | 4500 | 2065 | 2065 | 5013 | 5013 | 5484 | 5484 | 1470 | 1080 | 400 | 400 | 6 | 6 | 1200 | 1400 | — | — |
| | TFM480 | 4800 | 2165 | 2165 | 5313 | 5313 | 5784 | 5784 | 1570 | 1180 | 400 | 400 | 6 | 6 | 1100 | 1300 | — | — |
| | TFM500 | 5000 | 2265 | 2265 | 5513 | 5513 | 5984 | 5984 | 1670 | 1280 | 400 | 400 | 6 | 6 | 950 | 1200 | 1150 | 1300 |
| | TFM540 | 5400 | 2390 | 2390 | 5913 | 5913 | 6384 | 6384 | 1795 | 1405 | 400 | 400 | 3 | 6 | 900 | 1050 | 950 | 1100 |
| | TFM600 | 6000 | 2615 | 2615 | 6513 | 6513 | 6984 | 6984 | 2020 | 1630 | 400 | 400 | 3 | 6 | 450 | 550 | 750 | 900 |
| TFM650 | 6500 | 2830 | 2830 | 7010 | 7010 | 7484 | 7484 | 2235 | 1845 | 400 | 400 | 3 | 6 | 250 | 300 | 550 | 700 | |



M SERIES 2.5t IC Forklift

| General | 1 | Model | FD25T-M3VV3 | FGL25T-M3WA3 | | |
|---------------------------|-------------------------------------|---------------------------------------|---------------------------------------|----------------|-------|------|
| | 2 | Type | Diesel | Gasoline&LPG | | |
| | 3 | Optional Type | WE3/WB3/G(1)3/GK3/G(2)3/GF3 | / | | |
| | 4 | Rated capacity | kg | 2500 | | |
| | 5 | Load centre | mm | 500 | | |
| Characteristics&Dimension | 6 | Lift height | mm | 3000 | | |
| | 7 | Free lift height | mm | 160 | | |
| | 8 | Fork size | L×W×T | 1070×122×40 | | |
| | 9 | Fork regulating range | Min./Max. | 250/1040 | | |
| | 10 | Mast tilt angle | F/R | 6°/12° | | |
| | 11 | Front overhang | mm | 475 | | |
| | 12 | Rear overhang | mm | 517 | | |
| | 13 | Min. ground clearance(Bottom of mast) | mm | 125 | | |
| | 14 | Overall dimensions | Length to face of fork (without fork) | mm | 2545 | |
| | | | Overall width | mm | 1150 | |
| | | | Mast lowered height | mm | 2010 | |
| | | | Mast extended height(with backrest) | mm | 4025 | |
| | | | Overhead guard height | mm | 2145 | |
| | 18 | Overhead guard height | mm | 2145 | | |
| | 19 | Turning radius(outside) | mm | 2330 | | |
| | 20 | Min. right angle stacking aisle width | Pallet size a12=1000,b12=1200 | mm | 4005 | |
| | | | Pallet size a12=1200,b12=800 | mm | 4205 | |
| | Performance | 21 | Travel(Unladen) | km/h | 19 | |
| | | 22 | Speed | Lifting(Laden) | mm/s | 510 |
| Lowering(Laden) | | | | mm/s | 450 | |
| 24 | | Max. Drawbar pull | KN | 16 | | |
| 25 | | Max. Gradeability(Loaden) | % | 20 | | |
| Tyre | 26 | Tyre | Front | 7.00-12-12 PR | | |
| | | | Rear | 6.00-9-10 PR | | |
| | 28 | Tread | Front | mm | 970 | |
| | | | Rear | mm | 980 | |
| | 30 | Wheelbase | mm | 1600 | | |
| Weight | 31 | Self weight | kg | 3640 | | |
| | 32 | Weight Distribution | Laden | Front Axle | kg | 5480 |
| | | | | Rear Axle | kg | 660 |
| | | | Unladen | Front Axle | kg | 1470 |
| | | | | Rear Axle | kg | 2170 |
| Power&Transmission | 36 | Battery | Voltage/Capacity | V/Ah | 12/90 | |
| | 37 | Manufacture | Type | China | | |
| | | | Type | China | | |
| | | | Type | Powershift | | |
| | 38 | Transmission | Stage | F/R | | |
| 39 | Transmission | Stage | F/R | | | |
| 40 | Operating pressure(For attachments) | MPa | 17.5 | | | |



XINCHAI
Type: G(1)3
Model: 4D27G31-D12
Rated output: 36.8kw/2500rpm
Rated torque: 156 N·m / 1700-1900rpm
No. of cylinder:4
Bore × Stroke:90 × 105mm
Displacement:2.67L



DACHAI
Type: G(2)3
Model: CA498(Eu IIIA)
(Chinese DEUTZ)
Rated output: 36.9kw/2500 rpm
Rated torque: 190 N·m / 1800 rpm
No. of cylinder:4
Bore × Stroke: 98 × 105 mm
Displacement: 3.168 L



DACHAI
Type: GK3
Model: 498
(Chinese DEUTZ)
Rated output: 45kw/2500 rpm
Rated torque: 190 N·m / 1800 rpm
No. of cylinder:4
Bore × Stroke: 98 × 105 mm
Displacement: 3.168 L



XINCHAI
Type:GF3
Model: C490 (Eu IIIA)
Rated output:36.8kw/2650rpm
Rated torque: 156/148N·m/1700-1900rpm
No. of cylinder:4
Bore × Stroke:90×105
Displacement:2.67



YANMAR
Type:WE3
Model:4TNE98 (Eu IIIA)
Rated output:42.1kw/2300rpm
Rated torque: 186-208N·m/1700rpm
No. of cylinder:4
Bore × Stroke:98×110mm
Displacement:3.318L



ISUZU
Type:WB3
Model: C240NKFC01 (Eu IIIA)
Rated output:34.6kw/2500rpm
Rated torque:139N·m/1800rpm
No. of cylinder:4
Bore × Stroke:86 × 102mm
Displacement:2.369L



MITSUBISHI
Type: WV3
Model: S4S (Eu IIIA)
Rated output: 34.4kw/2300rpm
Rated torque: 182N·m/1800rpm
No. of cylinder:4
Bore × Stroke: 94 × 120mm
Displacement: 3.331L



GCT
Type: WA3
Model: K25
Rated output: 37.4kw/2300rpm
Rated torque: 171.2N·m/1600rpm
No. of cylinder:4
Bore × Stroke:89 × 100mm
Displacement:2.488L



Diesel



Gasoline/LPG

M SERIES 2.5t mast:

| Type | Model | Max. fork height | Overall height | | | Free lift | | Front Overhang | Tilt range | | Capacity | |
|------------------------|--------|------------------|----------------|----------|------------------|------------------|---------------|----------------|------------|-----|------------------------|-------------|
| | | | Lowered | Extended | | Without backrest | with backrest | | FWD | BWD | load capacity at 500mm | |
| | | | | 2.5t | Without backrest | | | | | | With backrest | Single tyre |
| | | mm | mm | mm | mm | mm | mm | Deg | Deg | kg | kg | |
| 2-stage mast | M330 | 3300 | 2160 | 3875 | 4290 | 160 | 160 | 465 | 6 | 12 | 2500 | — |
| | M350 | 3500 | 2260 | 4075 | 4490 | 160 | 160 | 465 | 6 | 12 | 2500 | — |
| | M370 | 3700 | 2360 | 4275 | 4690 | 160 | 160 | 465 | 6 | 6 | 2500 | — |
| | M400 | 4000 | 2560 | 4575 | 4990 | 160 | 160 | 465 | 6 | 6 | 2500 | — |
| | M450 | 4500 | 2810 | 5075 | 5490 | 160 | 160 | 465 | 6 | 6 | 2100 | 2400 |
| | M500 | 5000 | 3060 | 5575 | 5990 | 160 | 160 | 465 | 6 | 6 | 1600 | 1900 |
| Full free 2-stage mast | M550 | 5500 | 3360 | 6075 | 6490 | 160 | 160 | 465 | 3 | 6 | 1200 | 1700 |
| | M600 | 6000 | 3610 | 6575 | 6990 | 160 | 160 | 465 | 3 | 6 | 900 | 1400 |
| | TFM300 | 3000 | 2010 | 3590 | 3990 | 1420 | 1020 | 480 | 6 | 12 | 2500 | — |
| | TFM330 | 3300 | 2160 | 3890 | 4290 | 1570 | 1170 | 480 | 6 | 12 | 2500 | — |
| | TFM350 | 3500 | 2260 | 4090 | 4490 | 1670 | 1270 | 480 | 6 | 6 | 2500 | — |
| Full free 3-stage mast | TFM435 | 4350 | 2010 | 4867 | 5340 | 1390 | 1020 | 485 | 6 | 6 | 2200 | 2400 |
| | TFM450 | 4500 | 2060 | 5017 | 5490 | 1440 | 1070 | 485 | 6 | 6 | 2000 | 2300 |
| | TFM480 | 4800 | 2160 | 5317 | 5790 | 1540 | 1170 | 485 | 6 | 6 | 1700 | 2000 |
| | TFM500 | 5000 | 2260 | 5517 | 5990 | 1640 | 1270 | 485 | 6 | 6 | 1500 | 1800 |
| | TFM540 | 5400 | 2385 | 5917 | 6390 | 1765 | 1395 | 485 | 3 | 6 | 1200 | 1600 |
| | TFM600 | 6000 | 2610 | 6517 | 6990 | 1990 | 1620 | 485 | 3 | 6 | 800 | 1300 |
| TFM650 | 6500 | 2825 | 7000 | 7490 | 2200 | 1830 | 485 | 3 | 6 | 500 | 1000 | |

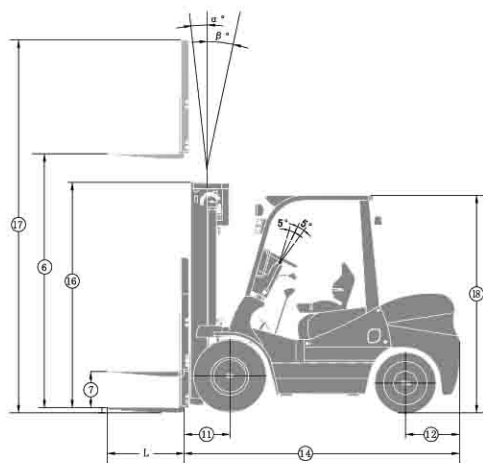
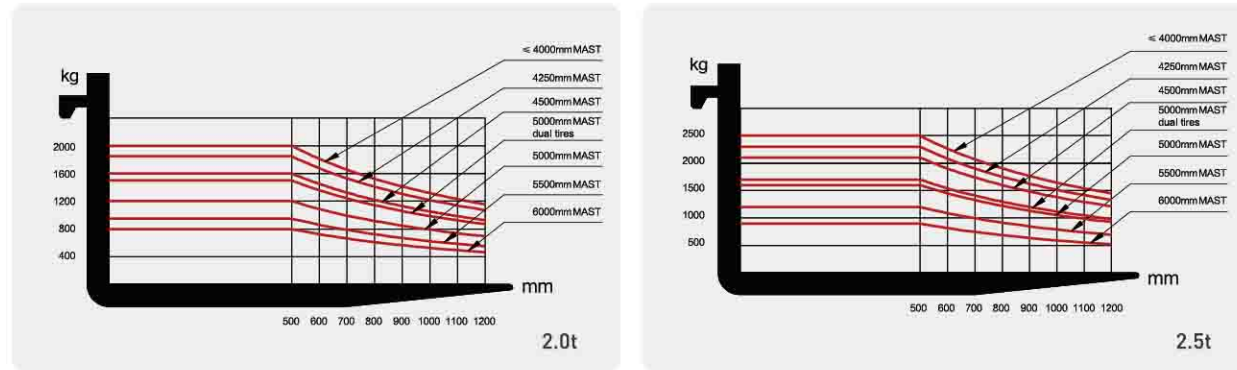

a=200 mm safety clearance
 $AST = a + \textcircled{11} + \textcircled{19} + \sqrt{W^2 + (B/2)^2}$

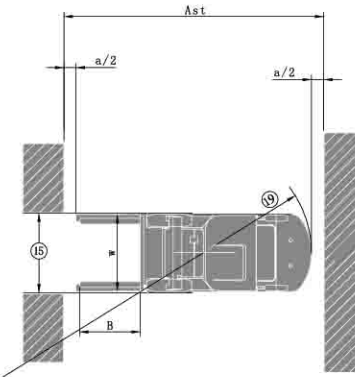

M SERIES 3.0-compact 4.0t Diesel Forklift

| General | | Model | FD30T-M3WV3 | FD35T-M3WV3 | FD40T-M3WV3 | | |
|---------|---------------------------------------|---------------------------------------|-----------------------------|-------------------------------|---------------------|---------------|------|
| 1 | Model | | FD30T-M3WV3 | FD35T-M3WV3 | FD40T-M3WV3 | | |
| 2 | Type | | Diesel | Diesel | Diesel | | |
| 3 | Optional Type | | WE3/WB3/G(1)3/GK3/G(2)3/GF3 | WE3/G(5)3/G(1)3/GK3/G(2)3/GF3 | WE3/G(5)3/GK3/G(2)3 | | |
| 4 | Rated capacity | kg | 3000 | 3500 | 4000 | | |
| 5 | Load centre | mm | 500 | 500 | 500 | | |
| 6 | Lift height | mm | 3000 | 3000 | 3000 | | |
| 7 | Free lift height | mm | 165 | 170 | 170 | | |
| 8 | Fork size | L×W×T | mm | 1070×122×45 | 1070×122×50 | 1070×122×50 | |
| 9 | Fork regulating range | Min./Max. | mm | 250/1100 | 260/1100 | 30/1100 | |
| 10 | Mast tilt angle | F/R | Deg | 6°/12° | 6°/12° | 6°/12° | |
| 11 | Front overhang | mm | 490 | 510 | 510 | | |
| 12 | Rear overhang | mm | 518 | 580 | 535 | | |
| 13 | Min. ground clearance(Bottom of mast) | mm | 140 | 140 | 150 | | |
| 14 | Overall dimensions | Length to face of fork (without fork) | mm | 2680 | 2755 | 2915 | |
| 15 | | Overall width | mm | 1210 | 1210 | 1410 | |
| 16 | | Mast lowered height | mm | 2075 | 2150 | 2260 | |
| 17 | | Mast extended height(with backrest) | mm | 4140 | 4140 | 4140 | |
| 18 | | Overhead guard height | mm | 2170 | 2170 | 2330 | |
| 19 | Turning radius(outside) | mm | 2450 | 2510 | 2715 | | |
| 20 | Min. right angle stacking aisle width | Pallet size a12=1000,b12=1200 | mm | 4140 | 4220 | 4425 | |
| 20 | | Pallet size a12=1200,b12=800 | mm | 4340 | 4420 | 4625 | |
| 21 | Speed | Travel(Unladen) | km/h | 18.5 | 18.5 | 18 | |
| 22 | | Lifting(Laden) | mm/s | 410 | 330 | 430 | |
| 23 | | Lowering(Laden) | mm/s | 430 | 430 | 425 | |
| 24 | Max. Drawbar pull | KN | 17 | 17 | 17 | | |
| 25 | Max. Gradeability(Laden) | % | 15 | 15 | 15 | | |
| 26 | Tyre | Front | | 28×9-15-14 PR | 28×9-15-14 PR | 250-15-16 PR | |
| 27 | | Rear | | 6.50-10-10 PR | 6.50-10-10 PR | 6.50-10-10 PR | |
| 28 | Tread | Front | mm | 1000 | 1000 | 1154 | |
| 29 | | Rear | mm | 980 | 980 | 980 | |
| 30 | Wheelbase | mm | 1700 | 1700 | 1900 | | |
| 31 | Self weight | kg | 4280 | 4700 | 5050 | | |
| 32 | Weight Distribution | Laden | Front Axle | kg | 6500 | 7250 | 8240 |
| 33 | | | Rear Axle | kg | 780 | 950 | 810 |
| 34 | | Unladen | Front Axle | kg | 1760 | 1670 | 2120 |
| 35 | | | Rear Axle | kg | 2520 | 3030 | 2930 |
| 36 | Battery | Voltage/Capacity | V/Ah | 12/90 | 12/90 | 12/90 | |
| 37 | | Manufacture | | China | China | China | |
| 38 | | Type | | Powershift | Powershift | Powershift | |
| 39 | Transmission | Stage | F/R | 1/1 | 1/1 | 1/1 | |
| 40 | Operating pressure(For attachments) | MPa | 17.5 | 17.5 | 17.5 | | |

M SERIES 3.0-3.5t Gasoline&LPG forklift



| General | | Model | | FGL30T-M3WA3 | FGL35T-M3WA3 | | | |
|--------------------------|---------------------------------------|---------------------------------------|---------------------------------------|--------------|---------------|----------------|----------------|----------------|
| 1 | Model | | | FGL30T-M3WA3 | FGL35T-M3WA3 | | | |
| 2 | Type | | | Gasoline&LPG | Gasoline&LPG | | | |
| 3 | Optional Type | | | / | / | | | |
| 4 | Rated capacity | kg | | 3000 | 3500 | | | |
| 5 | Load centre | mm | | 500 | 500 | | | |
| 6 | Lift height | mm | | 3000 | 3000 | | | |
| 7 | Free lift height | mm | | 165 | 170 | | | |
| Characteristic&Dimension | 8 | Fork size | L×W×T | 1070×122×45 | 1070×122×50 | | | |
| | 9 | Fork regulating range | Min./Max. | 250/1100 | 260/1100 | | | |
| | 10 | Mast tilt angle | F/R | 6°/12° | 6°/12° | | | |
| | 11 | Front overhang | | mm | 490 | 505 | | |
| | 12 | Rear overhang | | mm | 518 | 580 | | |
| | 13 | Min. ground clearance(Bottom of mast) | | mm | 140 | 140 | | |
| | Overall dimensions | 14 | Length to face of fork (without fork) | | mm | 2680 | 2750 | |
| | | 15 | Overall width | | mm | 1210 | 1210 | |
| | | 16 | Mast lowered height | | mm | 2075 | 2150 | |
| | | 17 | Mast extended height(with backrest) | | mm | 4140 | 4140 | |
| | | 18 | Overhead guard height | | mm | 2170 | 2170 | |
| | 19 | Turning radius(outside) | | mm | 2450 | 2510 | | |
| | Min. right angle stacking aisle width | 20 | Pallet size a12=1000,b12=1200 | | mm | 4140 | 4220 | |
| 20 | | Pallet size a12=1200,b12=800 | | mm | 4340 | 4420 | | |
| Performance | 21 | Travel(Unladen) | | km/h | 20 | 18.5 | | |
| | Speed | 22 | Lifting(Laden) | | mm/s | 420/460(WG3) | 420/360(WG3) | |
| | | 23 | Lowering(Laden) | | mm/s | 430 | 430/380(WG3) | |
| | 24 | Max. Drawbar pull | | KN | 17 | 17 | | |
| | 25 | Max. Gradeability(Laden) | | % | 20 | 18 | | |
| Tyre | Tyre | 26 | Front | | 28×9-15-14 PR | 28×9-15-14 PR | | |
| | | 27 | Rear | | 6.50-10-10 PR | 6.50-10-10 PR | | |
| | Tread | 28 | Front | | mm | 1000 | 1000 | |
| | | 29 | Rear | | mm | 980 | 980 | |
| | 30 | Wheelbase | | mm | 1700 | 1700 | | |
| Weight | 31 | | Self weight | | kg | 4260/4230(WG3) | 4680/4650(WG3) | |
| | Weight Distribution | Laden | 32 | Front Axle | | kg | 6460/6450(WG3) | 7220/7210(WG3) |
| | | | 33 | Rear Axle | | kg | 800/780(WG3) | 960/940(WG3) |
| | | Unladen | 34 | Front Axle | | kg | 1720/1710(WG3) | 1640/1630(WG3) |
| | | | 35 | Rear Axle | | kg | 2540/2520(WG3) | 3040/3020(WG3) |
| Power&Transmission | 36 | | Battery Voltage/Capacity | | V/Ah | 12/60 | 12/60 | |
| | 37 | | Manufacture | | | China | China | |
| | 38 | | Type | | | Powershift | Powershift | |
| | Transmission | 39 | Stage F/R | | | 1/1 | 1/1 | |
| | | 40 | Operating pressure(For attachments) | | MPa | 17.5 | 17.5 | |

| | | |
|--|--|---|
| <p>XINCHAI Type: G(1)3 Model: 4D27G31-012 Rated output: 36.8kw/2500rpm Rated torque: 156 N · m / 1700-1900rpm No. of cylinder:4 Bore × Stroke:90 × 105mm Displacement:2.67L</p> | <p>DACHAI Type: G(2)3 Model: CA498(Eu IIIA) (Chinese DEUTZ) Rated output: 36.9kw/2500 rpm Rated torque: 190 N · m / 1800 rpm No. of cylinder:4 Bore × Stroke: 98 × 105 mm Displacement: 3.168 L</p> | <p>DACHAI Type: GK3 Model: 498 (Chinese DEUTZ) Rated output: 45kw/2500 rpm Rated torque: 190 N · m / 1800 rpm No. of cylinder:4 Bore × Stroke: 98 × 105 mm Displacement: 3.168 L</p> |
| <p>XINCHAI Type: G(5)3 Model: 4D32G31-004 Rated output: 36.8kw/2400rpm Rated torque: 186 N · m / 1600-1800rpm No. of cylinder:4 Bore × Stroke: 98 × 105mm Displacement: 3.17L</p> | <p>XINCHAI Type: GF3 Model: C490 (Eu IIIA) Rated output: 36.8kw/2650rpm Rated torque: 156/148N·m/1700-1900rpm No. of cylinder:4 Bore × Stroke: 90 × 105 Displacement: 2.67</p> | <p>MITSUBISHI Type: WV3 Model: S4S (Eu IIIA) Rated output: 34.4kw/2300rpm Rated torque: 182 N · m / 1800rpm No. of cylinder:4 Bore × Stroke: 94 × 120mm Displacement: 3.331L</p> |
| <p>YANMAR Type: WE3 Model: 4TNE98 (Eu IIIA) Rated output: 42.1kw/2300rpm Rated torque: 186-206N·m/1700rpm No. of cylinder:4 Bore × Stroke: 98 × 110mm Displacement: 3.318L</p> | <p>ISUZU Type: WB3 Model: C240NKC01 (Eu IIIA) Rated output: 34.6kw/2500rpm Rated torque: 139N·m/1800rpm No. of cylinder:4 Bore × Stroke: 86 × 102mm Displacement: 2.369L</p> | <p>GCT Type: WA3 Model: K25 Rated output: 37.4kw/2300rpm Rated torque: 171.2N·m/1600rpm No. of cylinder:4 Bore × Stroke: 89 × 100mm Displacement: 2.488L</p> |

M SERIES M series 3-3.5t mast:

| Type | Model | Max. fork height | Overall height | | | | | | Free lift | | | | Front Overhang | | Tilt range | | Capacity | | | |
|------------------------|--------|------------------|----------------|------|------------------|------|---------------|------|------------------|------|---------------|------|----------------|------|------------|-----|------------------------|------|------|------|
| | | | Lowered | | Extended | | | | Without backrest | | with backrest | | 3t | 3.5t | FWD | BWD | load capacity at 500mm | | | |
| | | | 3t | 3.5t | Without backrest | | With backrest | | 3t | 3.5t | Single tyre | | | | | | Double tyre | | | |
| | | | mm | mm | mm | mm | mm | mm | mm | mm | mm | mm | mm | mm | Deg | Deg | kg | kg | kg | kg |
| 2-stage mast | M330 | 3300 | 2225 | 2300 | 3940 | 4000 | 4400 | 4400 | 165 | 170 | 165 | 170 | 485 | 505 | 6 | 12 | 3000 | 3500 | — | — |
| | M350 | 3500 | 2325 | 2400 | 4140 | 4200 | 4600 | 4600 | 165 | 170 | 165 | 170 | 485 | 505 | 6 | 12 | 3000 | 3500 | — | — |
| | M370 | 3700 | 2425 | 2500 | 4340 | 4400 | 4800 | 4800 | 165 | 170 | 165 | 170 | 485 | 505 | 6 | 6 | 3000 | 3500 | — | — |
| | M400 | 4000 | 2625 | 2700 | 4640 | 4700 | 5100 | 5100 | 165 | 170 | 165 | 170 | 485 | 505 | 6 | 6 | 3000 | 3300 | — | 3500 |
| | M450 | 4500 | 2875 | 2950 | 5140 | 5200 | 5600 | 5600 | 165 | 170 | 165 | 170 | 485 | 505 | 6 | 6 | 2600 | 2900 | 2800 | 3100 |
| | M500 | 5000 | 3125 | 3200 | 5640 | 5700 | 6100 | 6100 | 165 | 170 | 165 | 170 | 485 | 505 | 6 | 6 | 2100 | 2400 | 2400 | 2750 |
| Full free 2-stage mast | M550 | 5500 | 3425 | 3500 | 6140 | 6200 | 6600 | 6600 | 165 | 170 | 165 | 170 | 485 | 505 | 3 | 6 | 1700 | 1800 | 2200 | 2400 |
| | M600 | 6000 | 3675 | 3750 | 6640 | 6700 | 7100 | 7100 | 165 | 170 | 165 | 170 | 485 | 505 | 3 | 6 | 1300 | 1400 | 2000 | 2200 |
| | TFM300 | 3000 | 2075 | 2150 | 3650 | 3680 | 4100 | 4100 | 1425 | 1470 | 975 | 1050 | 495 | 515 | 6 | 12 | 3000 | 3500 | — | — |
| | TFM330 | 3300 | 2225 | 2300 | 3950 | 3980 | 4400 | 4400 | 1575 | 1620 | 1125 | 1200 | 495 | 515 | 6 | 12 | 3000 | 3500 | — | — |
| | TFM350 | 3500 | 2325 | 2400 | 4150 | 4180 | 4600 | 4600 | 1675 | 1720 | 1225 | 1300 | 495 | 515 | 6 | 6 | 3000 | 3500 | — | — |
| | TFM435 | 4350 | 2075 | 2150 | 4950 | 4990 | 5450 | 5450 | 1475 | 1510 | 975 | 1050 | 505 | 520 | 6 | 6 | 2800 | 3100 | 2900 | 3350 |
| Full free 3-stage mast | TFM450 | 4500 | 2125 | 2200 | 5100 | 5140 | 5600 | 5600 | 1525 | 1560 | 1025 | 1100 | 505 | 520 | 6 | 6 | 2500 | 2800 | 2700 | 3000 |
| | TFM480 | 4800 | 2225 | 2300 | 5400 | 5440 | 5900 | 5900 | 1625 | 1660 | 1125 | 1200 | 505 | 520 | 6 | 6 | 2250 | 2500 | 2450 | 2750 |
| | TFM500 | 5000 | 2325 | 2400 | 5600 | 5640 | 6100 | 6100 | 1725 | 1760 | 1225 | 1300 | 505 | 520 | 6 | 6 | 2100 | 2300 | 2300 | 2600 |
| | TFM540 | 5400 | 2450 | 2525 | 6000 | 6040 | 6500 | 6500 | 1850 | 1885 | 1350 | 1425 | 505 | 520 | 3 | 6 | 1650 | 1800 | 2100 | 2300 |
| | TFM600 | 6000 | 2675 | 2750 | 6600 | 6640 | 7100 | 7100 | 2075 | 2110 | 1575 | 1650 | 505 | 520 | 3 | 6 | 1200 | 1300 | 1900 | 2100 |
| TFM650 | 6500 | 2890 | 2965 | 7100 | 7100 | 7600 | 7600 | 2260 | 2290 | 1790 | 2865 | 505 | 520 | 3 | 6 | 700 | 800 | 1300 | 1500 | |

M SERIES compact4t mast:

| Type | Model | Max. fork height | Overall height | | | | Free lift | | Front Overhang compact4t | Tilt range | | Capacity | |
|------------------------|--------|------------------|----------------|------------------|---------------|------------------|---------------|-----|--------------------------|------------|------------------------|-----------------------|--|
| | | | Lowered | Extended | | Without backrest | with backrest | FWD | | BWD | load capacity at 500mm | | |
| | | | | Without backrest | With backrest | | | | | | Single tyre compact4t | Double tyre compact4t | |
| mm | mm | mm | mm | mm | mm | mm | Deg | Deg | kg | kg | | | |
| 2-stage mast | M330 | 3300 | 2410 | 4120 | 4400 | 170 | 170 | 505 | 6 | 12 | 4000 | — | |
| | M350 | 3500 | 2510 | 4320 | 4600 | 170 | 170 | 505 | 6 | 12 | 4000 | — | |
| | M370 | 3700 | 2610 | 4520 | 4800 | 170 | 170 | 505 | 6 | 6 | 4000 | — | |
| | M400 | 4000 | 2810 | 4820 | 5100 | 170 | 170 | 505 | 6 | 6 | 3700 | 4000 | |
| | M450 | 4500 | 3060 | 5320 | 5600 | 170 | 170 | 505 | 6 | 6 | 3100 | 3500 | |
| | M500 | 5000 | 3310 | 5820 | 6100 | 170 | 170 | 505 | 6 | 6 | 2600 | 3200 | |
| | M550 | 5500 | 3610 | 6320 | 6600 | 170 | 170 | 505 | 3 | 6 | 2100 | 2600 | |
| M600 | 6000 | 3860 | 6820 | 7100 | 170 | 170 | 505 | 3 | 6 | 1600 | 2400 | | |
| Full free 2-stage mast | FM300 | 3000 | 2260 | 3780 | 4100 | 1480 | 1160 | 518 | 6 | 12 | 4000 | — | |
| | FM330 | 3300 | 2410 | 4080 | 4400 | 1630 | 1310 | 518 | 6 | 12 | 4000 | — | |
| | FM350 | 3500 | 2510 | 4280 | 4600 | 1730 | 1410 | 518 | 6 | 6 | 4000 | — | |
| Full free 3-stage mast | TFM435 | 4350 | 2260 | 5100 | 5450 | 1510 | 1160 | 530 | 6 | 6 | 3300 | 3700 | |
| | TFM450 | 4500 | 2310 | 5250 | 5600 | 1560 | 1210 | 530 | 6 | 6 | 3000 | 3500 | |
| | TFM480 | 4800 | 2410 | 5550 | 5900 | 1660 | 1310 | 530 | 6 | 6 | 2700 | 3200 | |
| | TFM500 | 5000 | 2510 | 5750 | 6100 | 1760 | 1410 | 530 | 6 | 6 | 2500 | 3100 | |
| | TFM540 | 5400 | 2635 | 6150 | 6500 | 1885 | 1535 | 530 | 3 | 6 | 2000 | 2500 | |
| | TFM600 | 6000 | 2860 | 6750 | 7100 | 2110 | 1760 | 530 | 3 | 6 | 1500 | 2300 | |
| TFM650 | 6500 | 3075 | 7250 | 7600 | 2320 | 1970 | 530 | 3 | 6 | 1100 | 1900 | | |

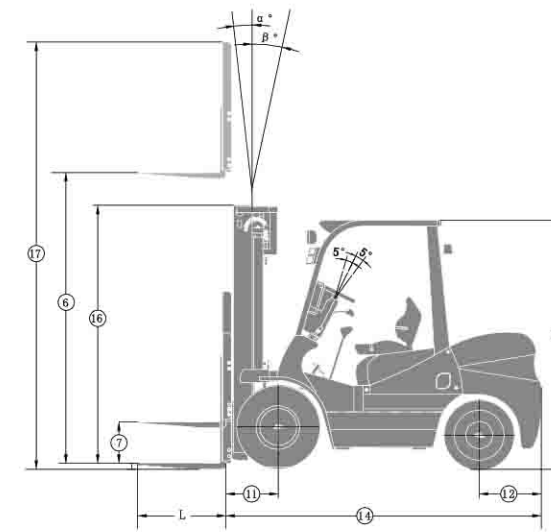

a=200 mm safety clearance
 $AST = a + ⑪ + ⑨ + \sqrt{W^2 + (B/2)^2}$

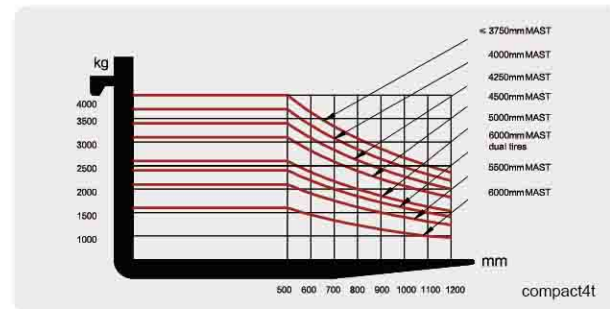
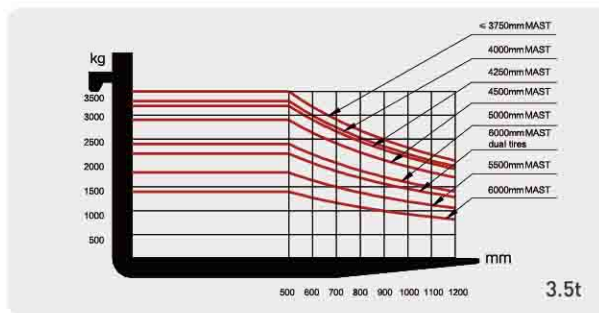
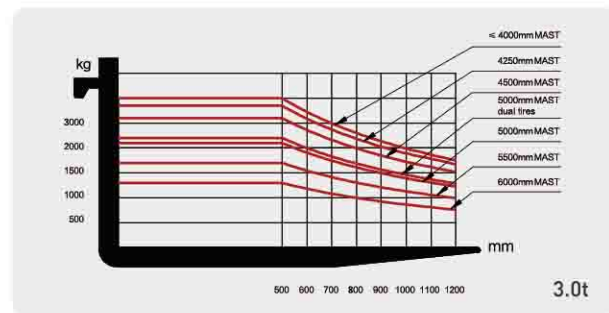
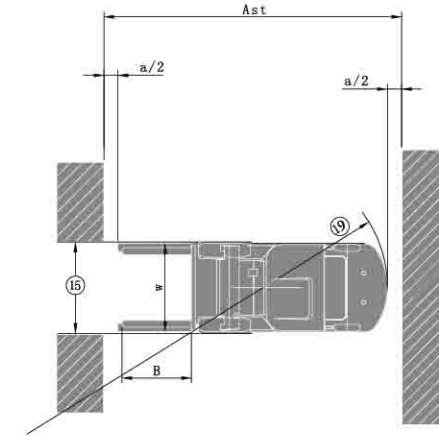



COMPANY MEMORABILIA

| | | |
|------|------|--|
| 2005 | Dec | Zhejiang Maximal Forklift Co., Ltd was officially established. |
| 2006 | Oct | M series forklifts displayed at the 100th Canton fair. |
| 2007 | Nov | Maximal phase I project of the new factory finished. |
| 2008 | Jan | Structure of electric forklift was further optimized. |
| | Nov | Maximal was appointed by the General Logistics Department of the People's Liberation Army(PLA) to be supplier for Military Equipment. |
| 2009 | Mar | 4.0T&5.0T and 8.0-10.0T diesel forklift were launched to enrich M Series. |
| | May | Maximal started to prepare the R&D of 16.0-18.0T diesel forklift. |
| 2010 | Nov | The first 4.5T electric forklift and 25.0T heavy duty forklift were displayed on Shanghai CeMAT. |
| | Dec | Maximal and Military Transportation University reached |
| 2012 | | Maximal was honored as "state-level high-tech enterprise". |
| 2013 | May | Maximal 2WD 2.5/3.5T Rough Terrain forklift was launched to the market. |
| | July | Maximal Empty Container Handler was officially developed. |
| 2014 | Jun | Maximal electric stackers & pallet trucks were put into market. |
| | Aug | Maximal 2WD Rough Terrain forklift were extended to 4.0/5.0T. |
| | Dec | Maximal phase II project was finished. |
| 2015 | May | Maximal 3.5T 4WD Rough Terrain forklift was successfully developed. First Reach Stacker successfully was sold in domestic market. |
| 2016 | July | Maximal won the Chinese well-known trademark. |
| | Oct | 1.8-3.5T C. 4WD Hydraulic rough terrain forklift was successfully launched. |
| 2018 | July | 3.5-4.5T Sider-loader forklift was lanuched; Electric forklift with lithium battery started to be developed; 1.6-2.5T A series Reach truck was lanuched. |
| | June | Hyster-Yale and Maximal officially completed its acquisition, Zhejiang Maximal Forklift Co., Ltd. renamed to Hyster-Yale Maximal Forklift (Zhejiang) Co., Ltd, began a new start. |